

ION | StormPro[®]

SHW50

Sewage Pump

Used For:

- Septic Tank Effluent
- Light Commercial Sewage
- High Capacity Sump
- Residential Sewage



ION™ **DIGITAL LEVEL CONTROL**
(patent pending & shown in photo)

Wide Angle Switch
Other switch type available

SHW50

Sewage Pump



37 Forestwood Drive, Romeoville, IL 60446
www.ionstormpro.com • 800 323 1665

Pump Specifications

Typical Applications	Sewage, high-capacity sump, effluent
Capacities	135 GPM
Head	30'
Electrical Data	115V, 9A, 1Ø, 60Hz
Motor Data	1/2 HP, 1625 RPM, PSC (1Ø), oil-filled
Liquids Handling	Domestic sewage and drain water
Intermittent Liquid Temp.	Up to 140°F
Minimum Sump Diameter	Simplex: 24" Duplex: 36"
Automatic Operation (Manual Available)	A: Ion Digital Level Control W: Wide angle switch M: Manual
Acceptable pH Range	5-9
Materials of Construction	Class 30 cast iron
Impeller	Thermoplastic
Power Cord	16/3, SJTW/SJTW-A, 10' standard, 20' optional
Discharge	2" NPT
Solids Handling	2"

Features:

- Carbon/ceramic Type 21 mechanical shaft seal
- Two-vane impeller design provides maximum pump efficiency
- Enclosed design for high-efficiency pumping
- Eliminates possibility of jamming between impeller and volute
- Original performance can be restored if wear occurs by replacing volute seal ring
- Durable motor will deliver many years of reliable service

Pump Dimensions

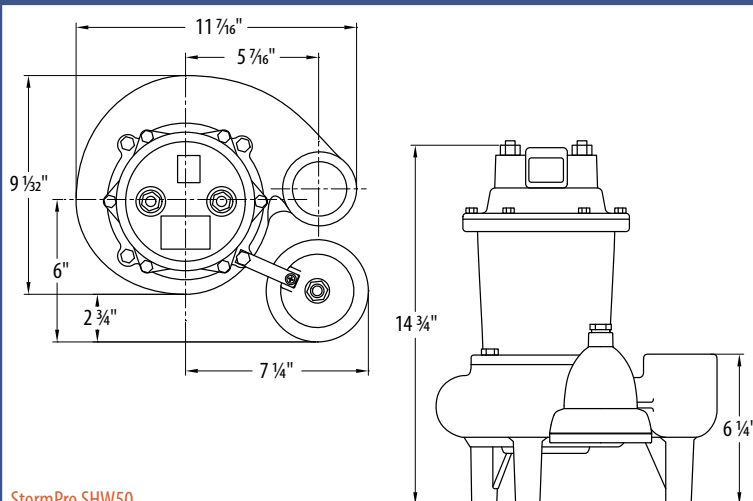

StormPro SHW50

Pump Performance Curve

