

ION | StormPro[®]

SHV40

Sewage Pump

Used For:

- Light Commercial Sewage
- Residential Sewage
- Septic Tank Effluent
- High Capacity Sump



 **DIGITAL LEVEL CONTROL**
(patent pending & shown in photo)

Wide Angle Switch
Other switch type available

SHV40

Sewage Pump



37 Forestwood Drive, Romeoville, IL 60446
www.ionstormpro.com • 800 323 1665

Pump Specifications

Typical Applications	Light commercial sewage, residential sewage, high-capacity sump, septic tank effluent
Maximum Capacity	90 GPM @ 0'
Maximum Head	0 GPM @ 25'
Electrical Data	115 V, 1 Ø, 8.5 FLA, 60 Hz 230 V, 1 Ø, 4.3 FLA, 60 Hz
Motor Data	1/2 HP, 1750 RPM
Intermittent Liquid Temp.	130°F
Minimum Sump Diameter	18" x 30"
Automatic Operation (Manual Available)	A: Ion Digital Level Control M: Manual
Materials of Construction	Cast iron stainless steel
Housing	Stainless steel
Impeller	Cast iron vortex
Power Cord	16/3, 20' Standard SJTW
Discharge	2" NPT
Solids Handling	2"

Features:

- Carbon ceramic shaft seal
- Mechanical seal
- Automatic reset thermal overload for maximum protection
- Lower single-row ball-bearing construction
- Piggyback plug available for easy maintenance and switch replacement

Pump Dimensions

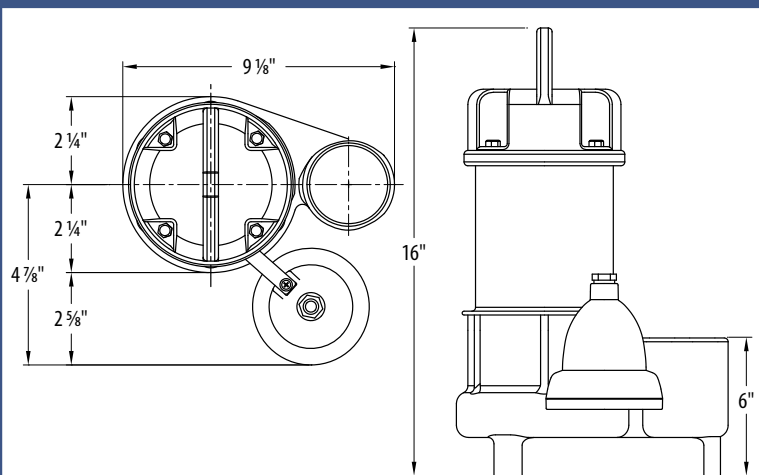

Pump Performance Curve

