

Product information presented here reflects conditions at time of publication. Consult factory regarding discrepancies or inconsistencies.



PUMP COMPANY

Zoeller Family of Water Solutions™

MAIL TO: P.O. BOX 16347 • Louisville, KY 40256-0347
SHIP TO: 3649 Cane Run Road • Louisville, KY 40211-1961
(502) 778-2731 • 1 (800) 928-PUMP • FAX (502) 774-3624

visit our web site:
www.zoeller.com

COMPARE THESE FEATURES

- Non-clogging vortex impeller.
- Durable cast construction. Cast iron switch case, motor and pump housing, base and impeller. No sheet metal parts to rust or corrode. All cast iron class 30 30000# tensile strength.
- Stainless steel screws, bolts, float rod, handle, guard and arm and seal assembly.
- Shaft Seal - Carbon & ceramic rotary face seal, with stainless steel wetted parts.
- UL Listed 3-wire neoprene cord and plug. 10 ft. standard for automatic. 15 ft. standard for nonautomatic.
- Upper and lower ball bearing running in a bath of oil.
- Maximum temperature for sewage or dewatering 130°F (54°C).
- Motor - 60 Hz, 1750 RPM, oil-filled, hermetically sealed, automatic reset thermal overload protected (1 Ph and Auto 3 Ph).
- All models are available in 2" or 3" discharge.
- All models pass 2 inch spherical solids.
- Automatic units available with float operated, submersible (NEMA 6) mechanical switch. Available in both 1 and 3 Phase Units.**
- On point 15¼", Off point 5¼".
- Corrosion resistant powder coated epoxy finish.
- Major width 13 9/16". Major height 19 9/16". (Single seal pumps)

MODELS 4282-4284 DOUBLE SEAL PUMPS (nonauto only)

- Protects motor from seal leaks.
- Improved bearing lubrication.
- Helps eliminate seal and bearing damage from dry runs.
- Major width 13 9/16". Height 21 7/16".

NOTE: The sizing of effluent systems normally requires variable level float(s) controls and properly sized basins to achieve required pumping cycles or dosing timers with nonautomatic pumps.



Tested to UL Standard
UL778

282 - 284 Single Seal Series
4282 - 4284 Double Seal Series

(For Pump Prefix Identification see News & Views 0052)



Certified to CSA Standard
C22.2 No. 108

"WASTE-MATE"

SUBMERSIBLE

SEWAGE

OR DEWATERING PUMP

2" OR 3" FLANGED DISCHARGE • PASSES 2" SOLIDS



**AUTOMATIC THREE
PHASE
PUMP****

**SINGLE
SEAL
PUMP**

**DOUBLE
SEAL
PUMP**



MODELS AVAILABLE

- Automatic or Nonautomatic with single seal
- Nonautomatic with double seals
- 2" or 3" discharge.
- Single phase or three phase motors available.
- See selection chart for specifications or specific models.

*NOTE: No UL Listing or CSA Certification for Extra Duty (ED) pumps.
See back page for UL & CSA Listings.

**THREE PHASE AUTOMATIC UNITS AVAILABLE IN 230V SINGLE SEAL ONLY.

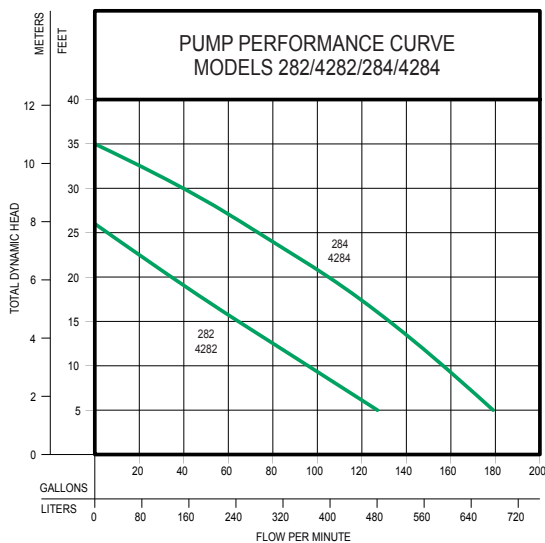

MODELS		282/4282		284/4284	
Feet	Meters	Gal.	Liters	Gal.	Liters
5	1.5	127	481	179	678
10	3.0	96	363	157	594
15	4.6	64	242	133	503
20	6.1	34	129	106	401
25	7.6	6	23	73	276
30	9.1	--	--	42	159
Shut-off Head		26 ft. (7.9m)		35 ft. (10.7m)	

**Single Seal Design
Weight 81-86 lbs.**

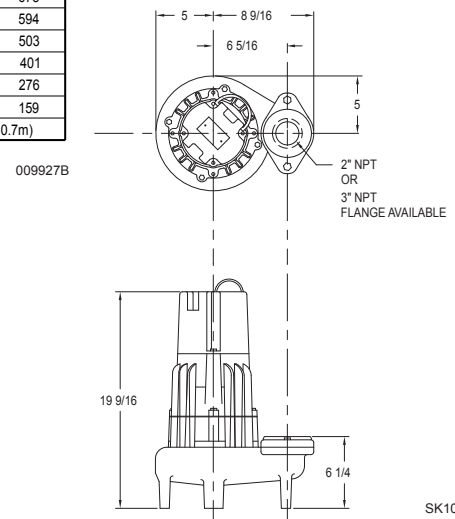

CONSULT FACTORY FOR SPECIAL APPLICATIONS

- Three phase pumps are available in 200V, 230V, 460V, or 575V. 230V three phase is available in automatic and nonautomatic models.
- Electrical alternators, for duplex systems, are available and supplied with a high water alarm, refer to FM0486.
- Simplex Panel with high water alarm, refer to FM1596.
- Variable level control switches are available for controlling single and three phase systems.
- Double piggyback variable level float switches are available for variable level long cycle controls.
- Long cords are available in lengths or 25 - 35 - 50 feet.
- Simplex and duplex basins are available.
- Refer to FM1922 and FM0806 for temperatures over 130°F.

**Double Seal Design
Weight 88-91 lbs.**

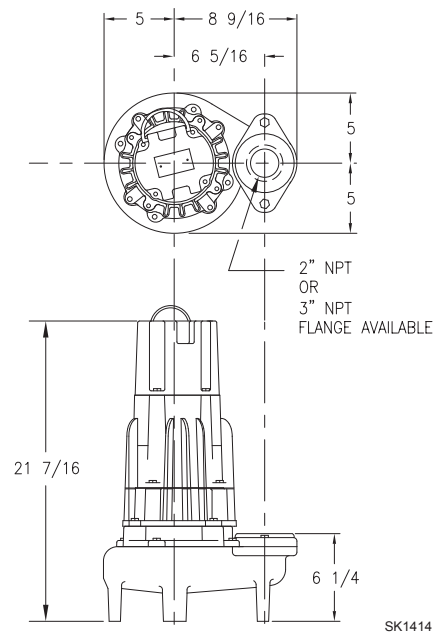

SPECIFICATIONS								CONTROL SELECTION		Listings	
Single Seal Model	Double Seal Model	Volt	Phase	Mode	Amps	HP	Cord Length	Simplex	Duplex	cCSAus	UL
M282	--	115	1Ph	Auto	10.3	1/2	10	1	--	Y	Y
N282	N4282	115	1Ph	Non	10.3	1/2	15	2 or 3	4	Y	Y
D282	--	230	1Ph	Auto	5.0	1/2	10	1	--	Y	Y
E282	E4282	230	1Ph	Non	5.0	1/2	15	2 or 3	4	Y	Y
* H282	--	200	1Ph	Auto	6.1	1/2	10	1	--	Y	N
* I282	* I4282	200	1Ph	Non	6.1	1/2	15	3	4	Y	N
* J282	* J4282	200	3Ph	Non	3.6	1/2	15	3	4	Y	Y
* F282	* F4282	230	3Ph	Non	3.0	1/2	15	3	4	Y	Y
* CF282	--	230	3Ph	Auto	3.0	1/2	15	1	--	N	Y
* G282	* G4282	460	3Ph	Non	1.7	1/2	15	3	4	Y	Y
* BA282	* BA4282	575	3Ph	Non	1.4	1/2	15	3	4	Y	N
D284	--	230	1Ph	Auto	8.9	1	10	1	--	Y	Y
E284	E4284	230	1Ph	Non	8.9	1	15	2 or 3	4	Y	Y
* H284	--	200	1Ph	Auto	9.3	1	10	1	--	Y	N
* I284	* I4284	200	1Ph	Non	9.3	1	15	3	4	Y	N
* J284	* J4284	200	3Ph	Non	5.5	1	15	3	4	Y	Y
* F284	* F4284	230	3Ph	Non	5.0	1	15	3	4	Y	Y
* CF284	--	230	3Ph	Auto	5.0	1	15	1	--	N	Y
* G284	* G4284	460	3Ph	Non	2.6	1	15	3	4	Y	Y
* BA284	* BA4284	575	3Ph	Non	2.2	1	15	3	4	Y	N

* No Molded Plug

For information on additional Zoeller products refer to catalog on Piggyback Variable Level Float Switches, FM0477; Electrical Alternator, FM0486; Sump/Sewage Basins, FM0487; Simplex Pump Control, FM1596; Alarm Systems, FM0732; and Disconnect/Rail Systems, FM0787.

CAUTION

All installation of controls, protection devices and wiring should be done by a qualified licensed electrician. All electrical and safety codes should be followed including the most recent National Electric Code (NEC) and the Occupational Safety and Health Act (OSHA).

RESERVE POWERED DESIGN

For unusual conditions a reserve safety factor is engineered into the design of every Zoeller pump.

© Copyright 2014 Zoeller Co. All rights reserved.