

# Grinder Pump Accessories

### Model GR20

For Standard Locations  
(Fits LSG and LSGX-Series Pumps)

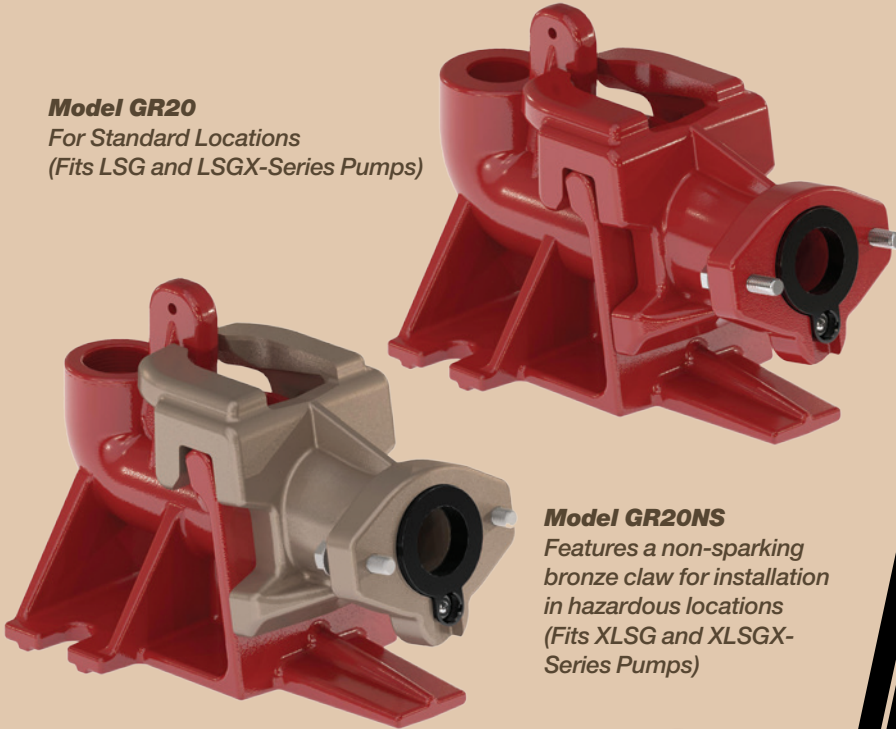

### Model GR20NS

Features a non-sparking  
bronze claw for installation  
in hazardous locations  
(Fits XLSG and XLSGX-  
Series Pumps)

Flanged Elbow,  
90 Degree



Anti-siphon  
Check Valve

### GR20-Series Guide Rail Base For Omnivore® Grinders

#### All GR20 models feature:

- Single guide pipe design with auto-align feature
- Powder coated for corrosion resistance
- Heavy nitrile sealing grommet
- Includes: mating flange, upper rail support bracket, stainless steel bolts and sealing grommet

#### Model GR20 Standard Location

- For LSG and LSGX-Series
- All cast iron
- 1-1/4" guide pipe threads FNPT
- 1-1/4" discharge threads FNPT

#### Model GR20NS Hazardous Location

- For XLSG and XLSGX-Series
- Cast iron base with bronze (non-sparking) mating claw
- 1-1/4" guide pipe threads FNPT
- 1-1/4" discharge threads FNPT

#### Model GR20-BSP British Parallel Thread

- For LSG and LSGX-Series
- All cast iron
- 1-1/4" guide pipe threads BSP
- 1-1/4" discharge threads BSP

### G90-Series Flanged Elbow, 90 Degree

- Fits all Omnivore® Series Grinders
- Provides vertical discharge for non-guide rail installations
- 1-1/4" female threaded outlet
- Heavy cast iron construction
- Powder coated for corrosion resistance
- Includes sealing grommet and stainless steel bolts

Model G90 1-1/4" FNPT

Model G90-BSP 1-1/4" British parallel thread

### ACV-Series Anti-siphon Check Valve

- 1-1/4" threaded female connections
- Heavy cast iron construction
- Integrated heavy weight nitrile ball check valve
- Anti-siphon feature breaks suction to prevent unwanted tank siphonage
- 125 PSI rated

Model ACV125 1-1/4" FNPT

Model ACV125-BSP 1-1/4" British parallel thread

# Grinder Pump Accessories

## DIMENSIONAL DATA

### Model G90 Flanged Elbow, 90 Degree

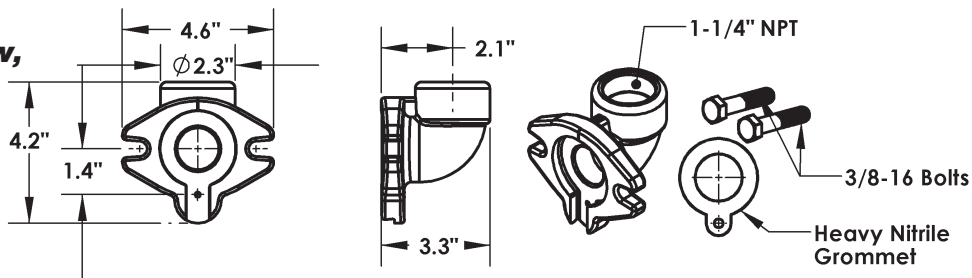

### ACV125 Anti-siphon Check Valve

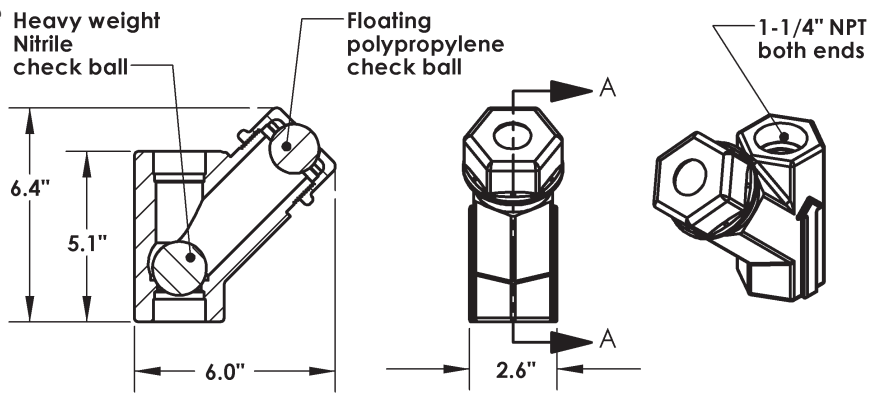

### Model GR20 and GR20NS Guide Rail Base

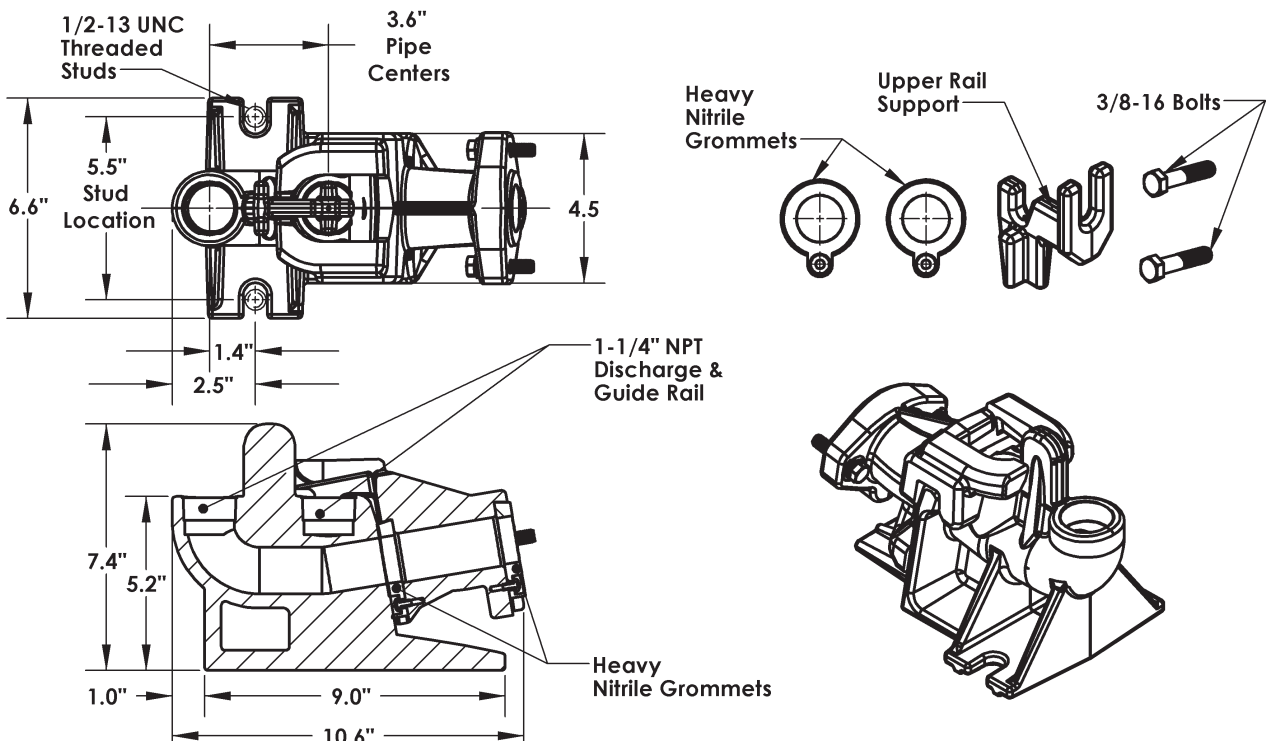

Specifications subject to change without notice.